

# Forged Steel Lift/Piston Type Check Valves, Threaded & Socket-welding End, CLASS 800 (PN 130)

**Class 800 (PN 130)**  
Full Port/Standard Port  
ASME CLASS 800: 1975 psi@100°F  
(136.2 bar@38°C)

## Features

- Meets API 602 required wall thickness / ASME B16.34
- Spiral wound gasket with SS304 / graphite or SS316 / graphite
- Horizontal type
- Valves with low Cv values
- Compact and sturdy designs for high pressure-temperature service

Forged steel  
check valve



Check Valve

25

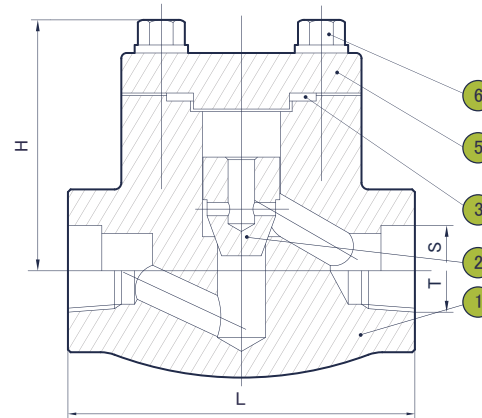

## Selection

Connection:  
Threaded End/Socket-welding End

Thread Type:  
NPT/BSPT/DIN

Material of the Body/Bonnet:  
A105/F316/F316L/F304/F304L/F11/F22

A spring can be added to the lift type  
check valve as a piston type one.

## Component and Common Materials

NO.	PARTS NAME	MATERIALS		
1	Body	A 105	A 182-F304	A 182-F316
2	Disc	13Cr	A 182-F304+STL	A 182-F316+STL
4	Gasket	SS304 & Graphite		SS316 & Graphite
5	Cap	A 105	A 182-F304	A 182-F316
6	Cap Bolt	A 193-B7		A 193-B8

\* Enclosed is a condensed table. For complete options, contact DIE ERSTE directly.

Nominal diameter	Standard Port	mm(in)	8(1/4)	10(3/8)	15(1/2)	20(3/4)	25(1)	32(1 1/4)	40(1 1/2)	50(2)
	Full port	mm(in)	-	-	10(3/8)	15(1/2)	20(3/4)	25(1)	32(1 1/4)	40(1 1/2)
D	mm(in)	7(0.28)	7(0.28)	11(0.43)	13(0.51)	18(0.71)	23(0.91)	28(1.10)	33(1.30)	42(1.65)
L	mm(in)	79(3.11)	79(3.11)	79(3.11)	92(3.62)	111(3.98)	120(4.72)	152(5.98)	172(6.77)	220(8.66)
H	mm(in)	62(2.44)	62(2.44)	62(2.44)	63(2.48)	78(3.07)	82(3.23)	102(4.02)	120(4.72)	147(5.79)
Weight	kg	1.5	1.4	1.2	1.4	2.3	3.9	5.6	8.9	12.5