

ITEM NO.

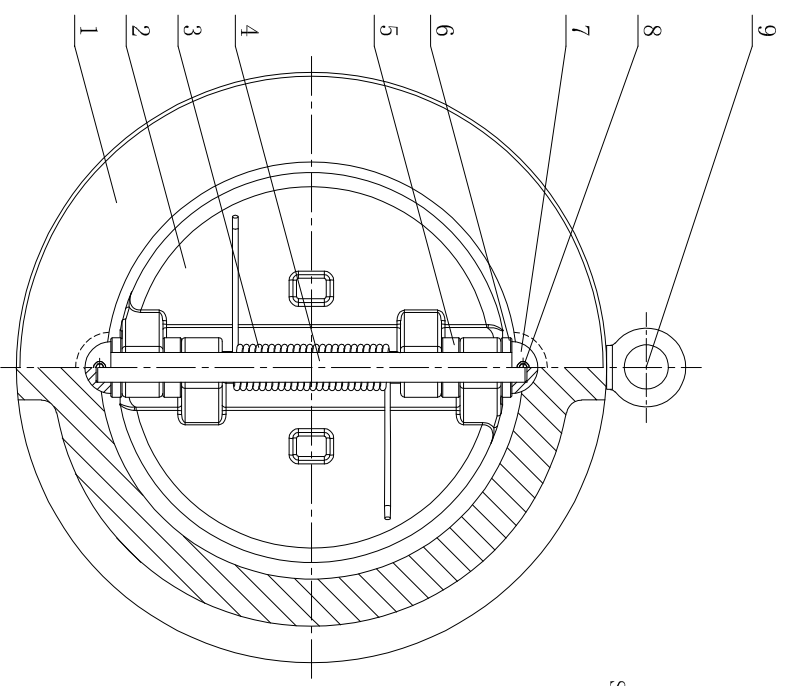
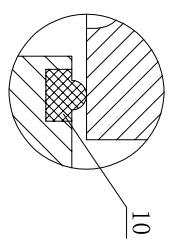
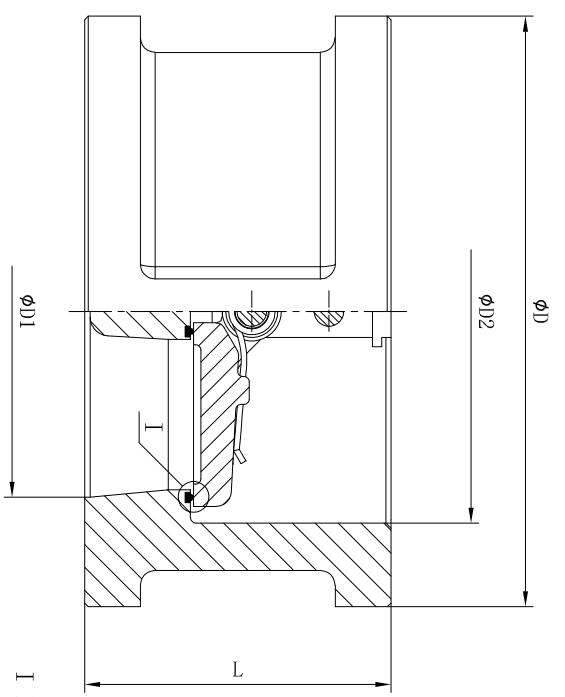

NOMINAL DIAMETER	MAIN DIMENSION (MM)					WEIGHT	
	NPS	DN	L	φD	φD1		φD2
1 1/2"	40	60	60	φ83	φ45	φ38	2 Kg
2"	50	60	60	φ103	φ58	φ51	2.5 Kg
2 1/2"	65	67	67	φ122	φ73	φ65	3 Kg
3"	80	73	73	φ135	φ88	φ80	4 Kg
4"	100	73	73	φ173	φ108	φ102	6 Kg
5"	125	86	86	φ195	φ132	φ127	8 Kg
6"	150	98	98	φ220	φ160	φ152	13 Kg
8"	200	127	127	φ277	φ210	φ203	25 Kg
10"	250	146	146	φ337	φ266	φ254	39 Kg
12"	300	181	181	φ407	φ310	φ305	54 Kg
14"	350	184	184	φ448	φ355	φ350	80 Kg
16"	400	191	191	φ512	φ405	φ400	117 Kg

**TECHNICAL SPECIFICATION**

1. DESIGN & MANUFACTURE ACCORDING TO API 594;  
 2. FACE TO FACE DIMENSION IN ACCORDANCE WITH API 594;  
 3. FLANGE ENDS DIMENSION COMPLY WITH ASME B16.5;  
 4. VALVE INSPECTION & TEST ACCORDING TO API 598.

PERFORMANCE SPECIFICATION	
SHELL TEST	3.0
BACK SEAT TEST	Mpa
SEAL HYDRO TEST	
SEAL AIR TEST	
SUITABLE TEMP	-20°C ~ +120°C
SUITABLE MEDIUM	WATER, OIL, GAS, STEAM, ETC

NO.	PART NAME	MATERIAL	REMARK	NO.	PART NAME	MATERIAL	REMARK
1	BODY	A216 WCB		10	SEAT	Viton	
2	DISC	A351 CF8M		11			
3	SPRING	Inconel X-750		12			
4	STEM	A182 F316		13			
5	DISC WASHER	A182 F316		14			
6	BODY WASHER	A182 F316		15			
7	BAFFLE BLOCK	A182 F316		16			
8	SET SCREW	A193 B8M		17			
9	LIFTING BOLT	SS316	NPS ≥ 8"	18			

DESIGN	DATE	DUAL PLATE WAFER CHECK VALVE NPS 1 1/2"~16" CLASS 150LB WAFER BODY: A216 WCB DISC: A351 CF8M SEAT: Viton STEM: A182 F316
CHECK	DATE	
APPROVED	DATE	

