

ITEM NO.

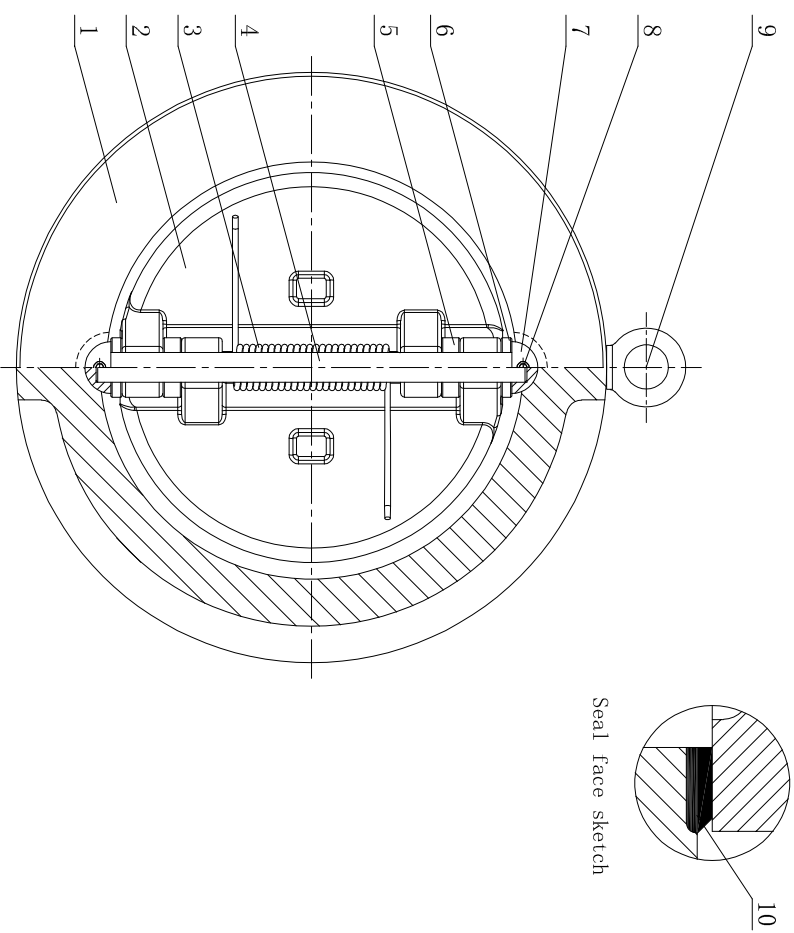
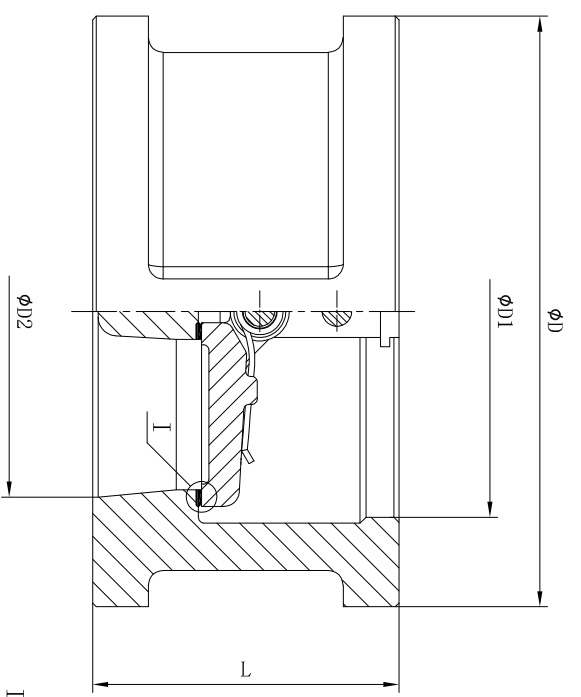

Seal face sketch

NOMINAL DIAMETER	MAIN DIMENSION (MM)					WEIGHT	
	NPS	DN	L	ϕD	$\phi D1$		$\phi D2$
1 1/2"	40	60	60	$\phi 83$	$\phi 45$	$\phi 38$	2 Kg
2"	50	60	60	$\phi 103$	$\phi 58$	$\phi 51$	2.5 Kg
2 1/2"	65	67	67	$\phi 122$	$\phi 73$	$\phi 65$	3 Kg
3"	80	73	73	$\phi 135$	$\phi 88$	$\phi 80$	4 Kg
4"	100	73	73	$\phi 173$	$\phi 108$	$\phi 102$	6 Kg
5"	125	86	86	$\phi 195$	$\phi 132$	$\phi 127$	8 Kg
6"	150	98	98	$\phi 220$	$\phi 160$	$\phi 152$	13 Kg
8"	200	127	127	$\phi 277$	$\phi 210$	$\phi 203$	25 Kg
10"	250	146	146	$\phi 337$	$\phi 266$	$\phi 254$	39 Kg
12"	300	181	181	$\phi 407$	$\phi 310$	$\phi 305$	54 Kg
14"	350	184	184	$\phi 448$	$\phi 355$	$\phi 350$	80 Kg
16"	400	191	191	$\phi 512$	$\phi 405$	$\phi 400$	117 Kg

TECHNICAL SPECIFICATION

- DESIGN & MANUFACTURE ACCORDING TO API 594
- FACE TO FACE DIMENSION IN ACCORDANCE WITH API 594
- FLANGE ENDS DIMENSION COMPLY WITH ASME B16.5
- VALVE INSPECTION & TEST ACCORDING TO API 598

PERFORMANCE SPECIFICATION

TEST PRESSURE		Mpa
SHELL TEST	3.0	
BACK SEAT TEST	2.2	
SEAL HYDRO TEST		
SEAL AIR TEST	0.6	
SUITABLE TEMP	-29°C ~ +425°C	
SUITABLE MEDIUM	WATER, OIL, GAS, STEAM, etc	

NO. PART NAME	MATERIAL	REMARK	NO. PART NAME	MATERIAL	REMARK
1 BODY	A216 WCB		10 SEAT SURFACE	SS316	
2 DISC	A351 CF8M				
3 SPRING	Inconel X-750				
4 STEM	A182 F316				
5 DISC WASHER	A182 F316		14		
6 BODY WASHER	A182 F316		15		
7 BAFFLE BLOCK	A182 F316		16		
8 SET SCREW	A193 B8M		17		
9 LIFTING BOLT	SS316	NPS \geq 8"	18		

DESIGN	DATE	DUAL PLATE WAFER CHECK VALVE
CHECK	DATE	
APPROVED	DATE	

NPS 1 1/2"~16" CLASS 150LB WAFER
 BODY: A216 WCB
 DISC: A351 CF8M
 SEAT: SS316
 STEM: A182 F316