

AISI 150LB,125LB/DIN PN16,PN10

SIZE	DN	L	Between Flange	ISO 5211 PAD NO.	φD1	φD2	n-φd	TXT	h	Torque N*M	Weight
1 1/2"	40	42	150LB/125LB/PN16/PN10	F05	φ90	φ50	4-φ8	9X9	30	17	2.2 KG
2"	50	42	150LB/125LB/PN16/PN10	F05	φ90	φ50	4-φ8	9X9	30	17	2.5 KG
2 1/2"	65	44.7	150LB/125LB/PN16/PN10	F05	φ90	φ50	4-φ8	9X9	30	25	2.7 KG
3"	80	45.2	150LB/125LB/PN16/PN10	F05	φ90	φ50	4-φ8	9X9	30	38	3.5 KG
4"	100	52.1	150LB/125LB/PN16/PN10	F07	φ90	φ70	4-φ10	11X11	30	56	4.4 KG
5"	125	54.4	150LB/125LB/PN16/PN10	F07	φ90	φ70	4-φ10	14X14	30	90	6.1 KG
6"	150	55.8	150LB/125LB/PN16/PN10	F07	φ90	φ70	4-φ10	14X14	30	124	7 KG
8"	200	60.6	150LB/125LB/PN16/PN10	F10	φ125	φ102	4-φ12	17X17	40	233	15 KG
10"	250	65.6	150LB/125LB/PN16/PN10	F10	φ125	φ102	4-φ12	22X22	45	392	21 KG
12"	300	76.9	150LB/125LB/PN16/PN10	F10	φ125	φ102	4-φ12	22X22	45	560	28 KG
14"	350	76.2	150LB/125LB/PN16/PN10	F10	φ125	φ102	4-φ12	22X22	45	736	41 KG
16"	400	85.7	150LB/125LB/PN16/PN10	F14	φ175	φ140	4-φ14	27X27	45	1011	65 KG

* 1. The torque without Safety factor.
 * 2. Safety factor of 1.3 is recommended.

7	O-Ring	Viton		
6	Short Bushing	PTFE	2	
5	Seat	RPTFE	1	
4	Disc	Duplex 2205	1	
3	Stem	A182 F51	1	
2	Long Bushing	PTFE	2	
1	Body	Duplex 2205	1	

NO.	NAME	MATERIAL	QTY	REMARK
TEST PRESSURE	CWP:16Bar	SHELL		SEAL
	HYDROSTATIC	24 bar		17.6 bar
	AIR	6 bar		6 bar

STANDARD	DESIGN CODE	API 609
	INSPECTION & TEST	API 598
	END STANDARD	ASME 150LB, 125LB / DIN PN16, PN10
	FACE TO FACE	API 609
	WORKING TEMPERATURE	-29C° ~ +120C°

TITLE: CONCENTRIC BUTTERFLY VALVE SQUARE BARE SHAFT
 NPS 1 1/2"-16" - 150LB/125LB/PN16/PN10 - WAFER - Duplex 2205/Duplex 2205/RPTFE

APPROVED		DWG NO.	REV
CHECKED			
DRAWN			
DESIGNED		SCALE	UNIT mm

1	Nondestructive Testing		
1.1	Pressure Test	Mandatory	Yes
1.2	Chemical composition certification	Mandatory	Yes
1.3	Penetrant Test	All Body Surface	Yes
1.4	Magnetic particle testing	All Body Surface	Yes



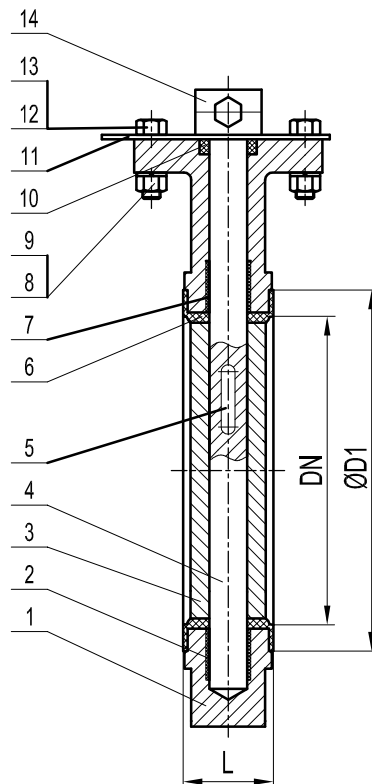
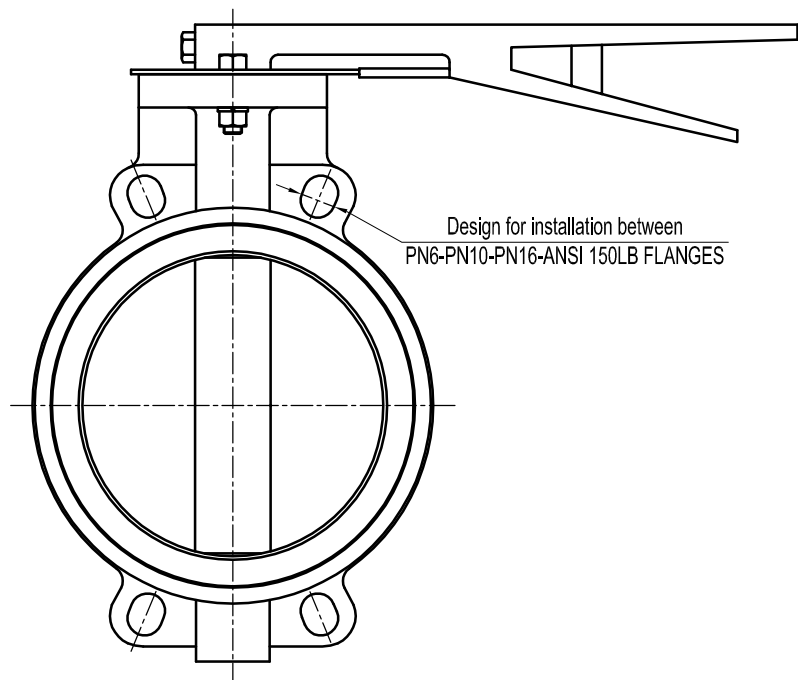

TECHNICAL REQUIREMENTS	SPECIFICATION	
	CLASS \ PN	150LB
	SHELL TEST PRE(HYD)	2.5
	SEAT TEST PRE(HYD)	1.8
	SEAT TEST PRE(AIR)	0.6
MPa		
APPLICABLE STANDARD		
DESIGN AND MANUFACTURE	API 609-1991	
FLANGE SIZE STANDARD	ANSI B16.5-2009	
FACE TO FACE STANDARD	ANSI B16.10-1992	
VALVE TEST INSPECTION	API 598-1994	

13	Nut	A194 8M	14	Lever	C/S
11	Limit Plate	ANSI 1025	12	Bolt	A193 B8M
9	Nut	A194 8M	10	Packing	PTFE
7	Upper Bushing	SS316 +Nitridation	8	Bolt	A193 B8M
5	Key	A182 F51	6	Seat	PTFE
3	Disc	A890 4A	4	Stem	A182 F51
1	Body	A890 4A	2	Lower Bushing	SS316 +Nitridation
No.	NAME	MATERIAL	No.	NAME	MATERIAL

Nominal Diameter		Valve general dimensions (Class150)	
In	DN	L	ØD1
2"	50	43	92
3"	80	46	127
4"	100	52	157
6"	150	56	216

PTV[®]
Solutions

CHECKED

DRAWN

P₁

ASSEMBLY DRAWING

WAFER TYPE CONCENTRIC BUTTERFLY VALVE

2"-6"D71F-150LB

WAFER TYPE

**SUITABLE MEDIUM
WATER, AIR, STEAM, OIL**