

NPS	d1	L	D	L1
1/2	9.5	79	21.8	9.6
3/4	12.5	92	27.1	12.7
1	17	111	33.8	12.7
1-1/4	21	120	42.6	12.7
1-1/2	28	152	48.7	12.7
2	36	172	61.1	15.9

Notice:

1. Design and manufacture by API 602
2. SW ends to ASME B16.11
3. Face to face dimensions to Manufacturer's standard
4. Pressure temperature rating by ASME B16.34
5. Valve tested by API 598

Performance Specification		
Pressure Rating		800LB
Test pressure	Shell test	21.0
	Back seal test	/
	Seal test	15.4
	Gas test	/
Max. working temperature		425 °C

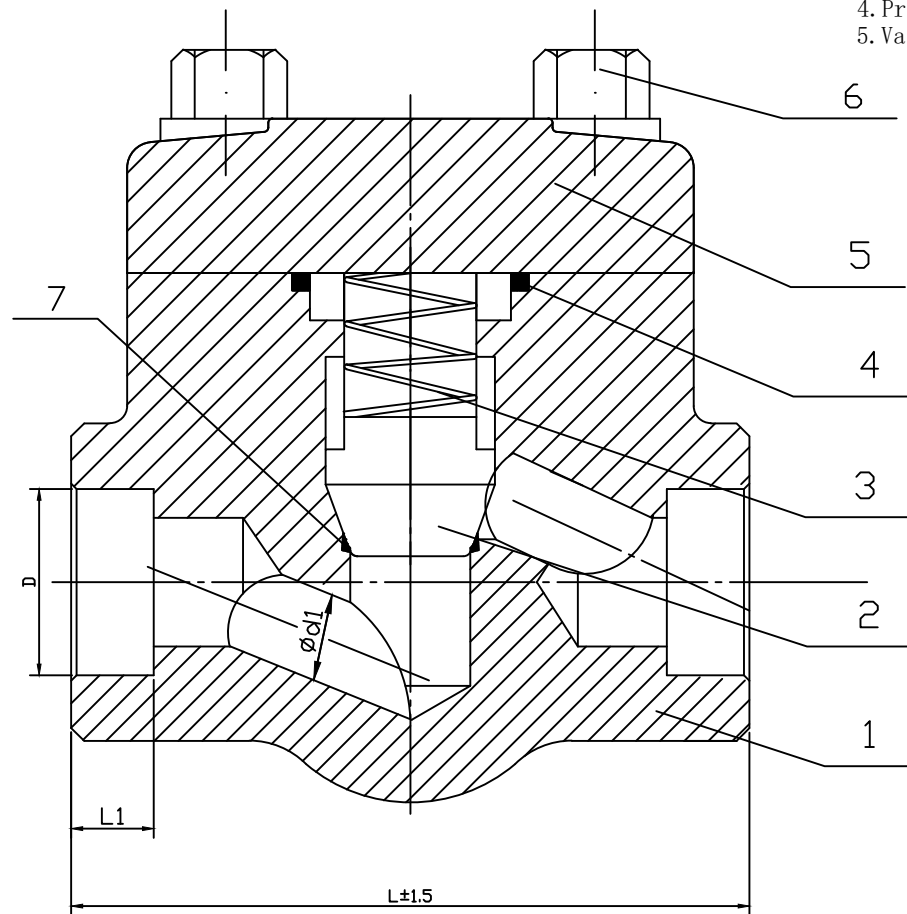

7	Seat	304
6	Bolt	A193 B7
5	Bonnet	ASTM A105
4	Gasket	304+Graphite
3	Spring	304
2	Disc	13Cr+STL
1	Body	ASTM A105
NO.	PART NAME	MATERIALS

DRAWN BY		
CHECKED BY		TITLE: CHECK VALVE Class800
APPROVED BY		DRG. NO: 1/2"-2" H61Y-800LB
DATE	2023	