

Features:

- 1. Design standard: API 594-2022/9
- 2. Face to face: API 594-2022/9
- 3. Flange ends: ASME B16.5-2020
- 4. Test& inspection: API 598-2016/10

SPECIFICATION				
Pressure	ANSI Class 150LB			
Pressure test	Shell(hydrostatic)	3.0	Mpa	
	Seat(hydrostatic)	2.2		
Application Temp. -29° C ~ 425° C				

Main Dimension(mm)

Item Code	L	D1	D
H76W-150Lb-2"	60	58	103
H76W-150Lb-2½"	67	74	122
H76W-150Lb-3"	73	90	135
H76W-150Lb-4"	73	110	173
H76W-150Lb-5"	86	132	195
H76W-150Lb-6"	98	156	220
H76W-150Lb-8"	127	204	278
H76W-150Lb-10"	146	266	337
H76W-150Lb-12"	181	324	407
H76W-150Lb-14"	184	355	448
H76W-150Lb-16"	191	405	512
H76W-150Lb-18"	203	455	547
H76W-150Lb-20"	219	505	604
H76W-150Lb-22"	222	555	657
H76W-150Lb-24"	222	605	715

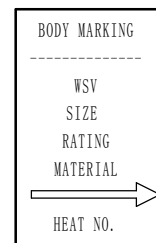
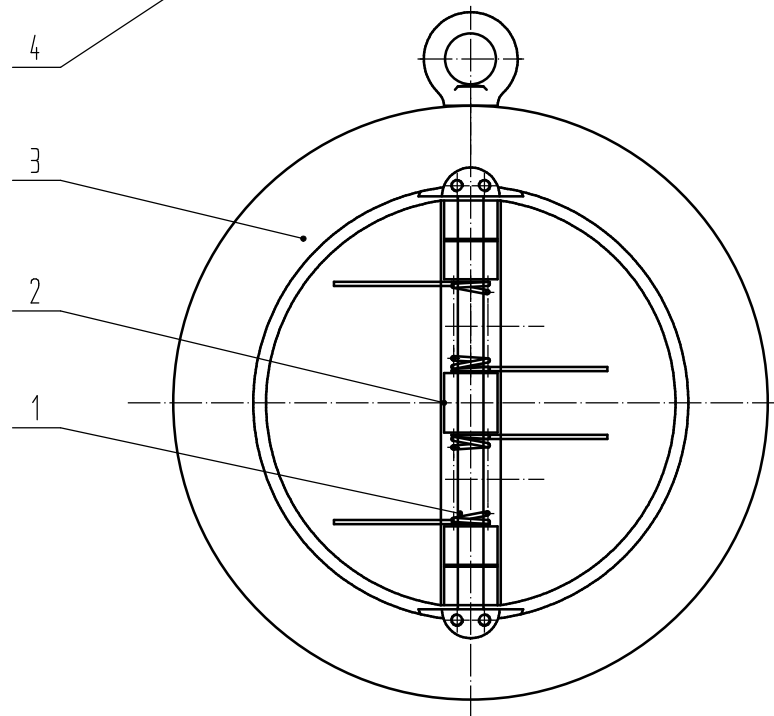
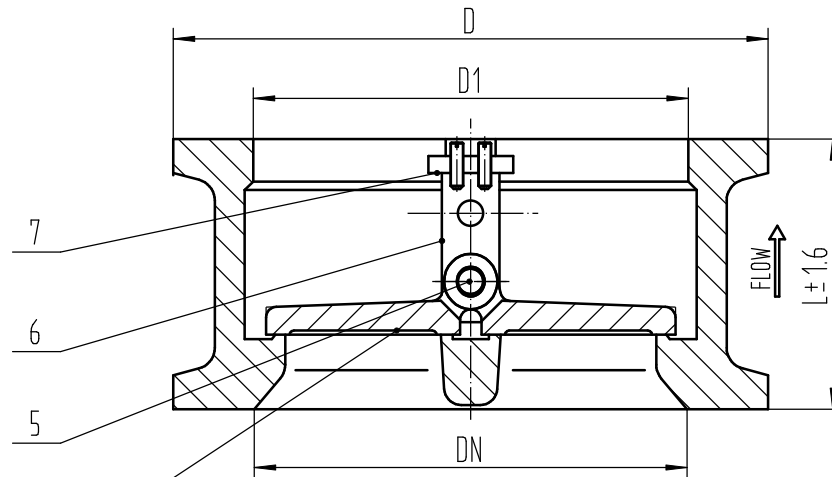

7	H76W-150LB-00	Locating plate	/	A182 F316	
6	H76W-150LB-00	Locating piece	/	A182 F316	
5	H76W-150LB-00	Pin	/	A182 F316	
4	H76W-150LB-00	Disc	/	A351 CF8M	
3	H76W-150LB-00	Body	/	A351 CF8M	
2	H76W-150LB-00	Locating cover	/	A182 F316	
1	H76W-150LB-00	Spring	/	Inconel X750	

NO.	CODE	MAIN PARTS	QTY	MATERIAL	REMARKS
DESCRIPTION					DRAWING
DUO CHECK VALVE WAFER TYPE, 150LB BODY:A351 CF8M					<p><b>Weidouli special valve</b></p>
WEIDOU LI VALVES CO.,LTD.					

Features:

1. Design standard: API 594-2022/9
2. Face to face: API 594-2022/9
3. Flange ends: ASME B16.5-2020
4. Test & inspection: API 598-2016/10

SPECIFICATION			
Pressure	ANSI Class 150LB		
Pressure test	Shell (hydrostatic)	3.0	Mpa
	Seat (hydrostatic)	2.2	
Application Temp. -29° C ~ 150° C			

Main Dimension

Item Code	L	D1	D
H76W-150Lb-2"	60	58	103
H76W-150Lb-2½"	67	74	122
H76W-150Lb-3"	73	90	135
H76W-150Lb-4"	73	110	173
H76W-150Lb-5"	86	132	195
H76W-150Lb-6"	98	156	220
H76W-150Lb-8"	127	204	278
H76W-150Lb-10"	146	266	337
H76W-150Lb-12"	181	324	407
H76W-150Lb-14"	184	355	448
H76W-150Lb-16"	191	405	512
H76W-150Lb-18"	203	455	547
H76W-150Lb-20"	219	505	604
H76W-150Lb-22"	222	555	657
H76W-150Lb-24"	222	605	715

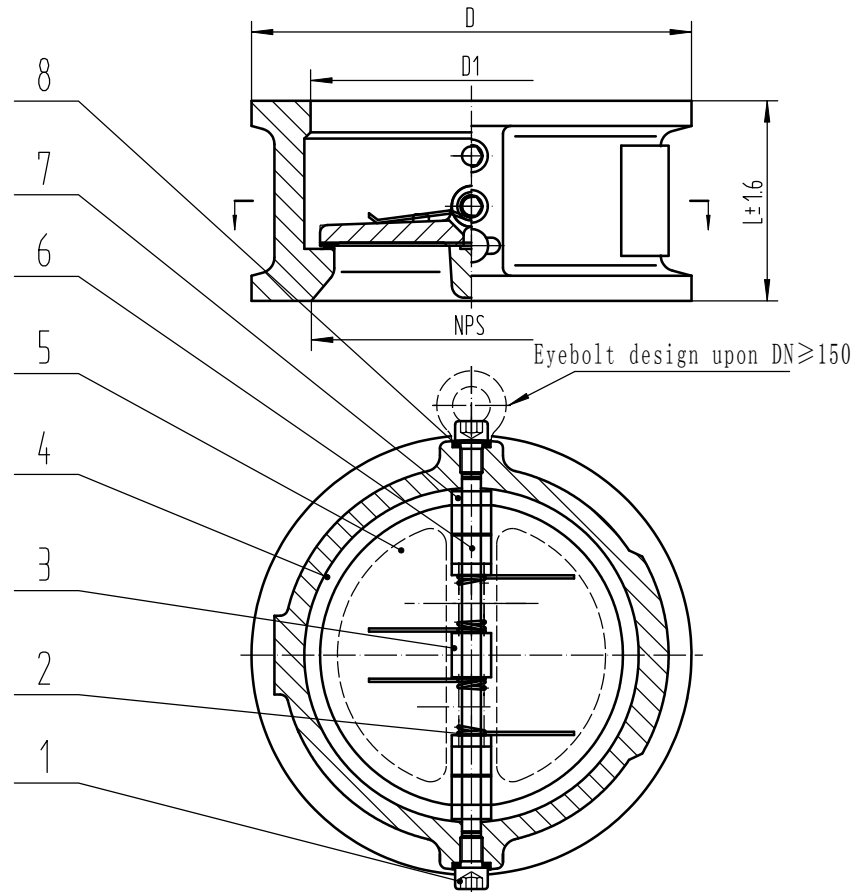

BODY MARKING	
WSV	SIZE
RATING	MATERIAL
HEAT NO.	

8	WSV006-2008	Gasket	/	PTFE	
7	H76W-150Lb-06	Locating piece	/	A182 F316	
6	H76W-150Lb-05	Pin	/	A182 F316	
5	H76W-150Lb-04	Disc	/	A351 CF8M	
4	H76W-150Lb-03	Body	/	A351 CF8M	
3	H76W-150Lb-02	Locating cover	/	A182 F316	
2	H76W-150Lb-01	Spring	/	Inconel X750	
1	GB/T 70.1-2000	Screw	/	SS316	

NO.	CODE	MAIN PARTS	QTY	MATERIAL	REMARKS		
		DESCRIPTION		DRAWING			
				<p><b>Weidouli special valve</b></p>			
SALES	DRAWN	ASSESS	AUTHORIZE			REV.	DATE
DRW. NO.	Ref. No.						
NOTES	ITEM						
WEIDOU LI VALVES CO., LTD.							