

BASIC

VALVOLA A SFERA A PASSAGGIO TOTALE SERIE UNIVERSALE FULL BORE BALL VALVE UNIVERSAL SERIES

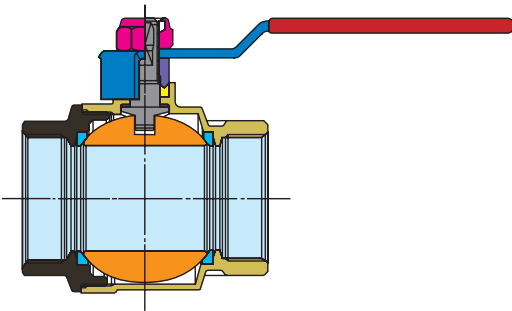

SPECIFICA MATERIALI MATERIAL SPECIFICATION



PARTICOLARI COMPONENT

MATERIALI MATERIAL

DESCRIZIONE DESCRIPTION

■ CORPO BODY	CW 617 N UNI EN 12165	STAMPATO DA BARRA, NICHELATO Forged, Nickel-Plated
■ MANICOTTO END ADAPTER	CW 617 N UNI EN 12165	STAMPATO DA BARRA, NICHELATO Forged, Nickel-Plated
■ SFERA BALL	CW 614 N UNI EN 12164	DA BARRA, NICHEL-CROMATA Machined, Chrome-Plated
■ SEDI LATERALI BALL GASKETS	PTFE	VERGINE Virgin
■ PERNO STEM	CW 614 N UNI EN 12164	DA BARRA Machined
■ ANELLO ANTIFRIZIONE THRUST WASHER	PTFE	VERGINE Virgin
■ GUARNIZIONE DI TENUTA SUP. STEM PACKING	PTFE	VERGINE Virgin
■ PREMIGUARNIZIONE GLAND	CW 614 N UNI EN 12164	DA BARRA, NICHELATO Machined, Nickel-Plated
■ LEVA LEVER HANDLE	ACCIAIO ZINCATO Zinc-Plated Steel	PLASTIFICATA IN PVC PVC Insulated
■ FARFALLA O LEVA LEVER OR T-HANDLE	ALLUMINIO Aluminium	VERNICIATA Painted
■ DADO AUTO-BLOCCANTE SELF-LOCKING NUT	ACCIAIO Steel	ZINCATO Zinc-Plated

FILETTATURE

Estremità filettate UNI ISO 228/1.

END CONNECTIONS

Threaded ends UNI ISO 228/1.

IMPIEGHI

Le valvole a sfera **BASIC** sono adatte per l'uso con acqua calda e fredda, aria compressa, oli e idrocarburi in generale. Per utilizzi speciali vedere le tabelle di compatibilità chimica.

APPLICATIONS

The **BASIC** ball valves are suitable for hot and cold water, compressed air, oils and hydrocarbons in general. For special uses please see the chemical resistance tables.

PRESSIONE DI ESERCIZIO

Da PN 80 (1/4") a PN 16 (4").
Vedere diagramma pressione/temperatura.

PRESSURE LIMITS

From PN 80 (size 1/4") to PN 16 (size 4").
See pressure/temperature diagram.

LIMITI DI TEMPERATURA

Da -20°C a +150°C.
Vedere diagramma pressione/temperatura.

TEMPERATURE LIMITS

From -20°C to + 150°C.
See pressure/temperature diagram.

FORO ANTILEGIONELLA DAL 1/2" AL 2" - ANTI LEGIONELLA HOLE FROM 1/2" TO 2"

Diagramma pressione/temperatura (prova eseguita con acqua)
Pressure/temperature diagram (tested with water)



Diagramma perdite di carico (prova eseguita con acqua)
Loss of head diagram (tested with water)



BASIC

VALVOLA A SFERA A PASSAGGIO TOTALE SERIE UNIVERSALE FULL BORE BALL VALVE UNIVERSAL SERIES

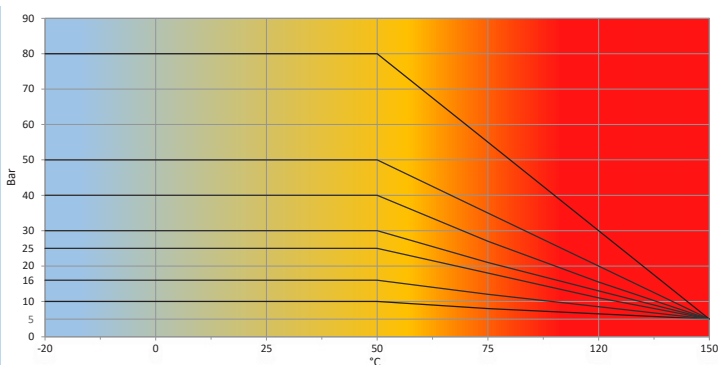
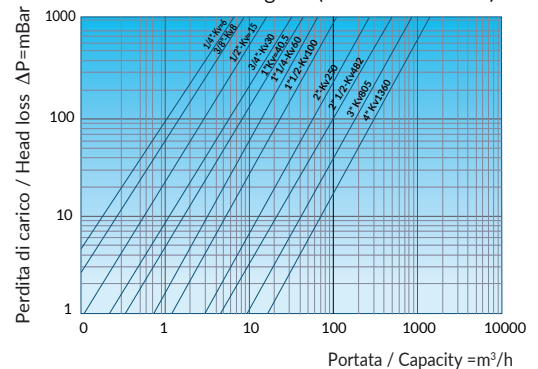
S0211 BASIC

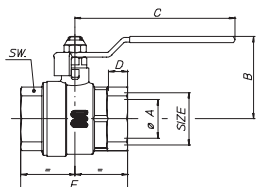

CODICE CODE	MISURA SIZE	PN Bar	øA	B	C	D	E	SW	Box Crt
S0211N02	¼" (DN10)	80	10	38	90	11	47,5	17	25/125
S0211N03	⅜" (DN10)	80	10	38	90	11,4	49,5	21	25/100
S0211N04	½" (DN 15)	50	15	39,5	90	9,5	49	25	15/75
S0211N05	¾" (DN20)	50	20	47,5	105	11	59	31	12/48
S0211N06	1" (DN25)	50	25	51,5	105	12,5	70	38	12/36
S0211N07	1¼" (DN32)	50	32	62	120	13,5	81	47	4/20
S0211N08	1½" (DN40)	40	40	71	140	15,5	94	54	4/8
S0211N09	2" (DN50)	40	50	85,5	170	17,5	112	66	2/8
S0211N10	2½" (DN65)	40	65	98,5	170	19,5	134	83	1/6
S0211N11	3" (DN82)	25	80	112,5	250	21	156	97	1/3
S0211N12	4" (DN100)	16	100	135,5	250	24,3	189	124	1/1

Valvola a sfera passaggio totale con leva acciaio, femmina/femmina, nichelata.
Full bore valve with steel handle, female/female, nickel-plated.

S0212 BASIC

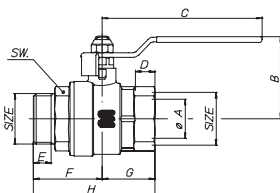

CODICE CODE	MISURA SIZE	PN Bar	øA	B	C	D	E	F	G	H	SW	Box Crt
S0212N04	½" (DN 15)	50	15	39,5	90	9,5	9,7	34,75	24,5	59,5	25	15/75
S0212N05	¾" (DN20)	50	20	47,5	105	11	10,7	40,5	29,5	70	31	12/48
S0212N06	1" (DN25)	50	25	51,5	105	12,5	11,7	44,5	35	79,5	38	8/32
S0212N07	1¼" (DN32)	50	32	62	120	13,5	13,2	47,5	40,5	88	47	4/20
S0212N08	1½" (DN40)	40	40	71	140	15,5	15,5	54,5	47	101,5	54	4/8
S0212N09	2" (DN50)	40	50	85,5	170	17,5	17,5	65	56	121	66	2/8

Valvola a sfera passaggio totale con leva acciaio, maschio/femmina, nichelata.
Full bore valve with steel handle, male/female, nickel-plated.

S0214 BASIC

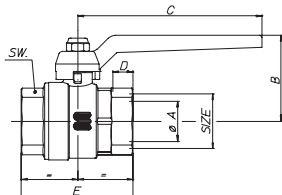
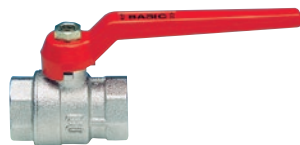

CODICE CODE	MISURA SIZE	PN Bar	øA	B	C	D	E	SW	Box Crt
S0214N02	¼" (DN10)	80	10	38,5	80	11	47,5	17	25/125
S0214N03	⅜" (DN10)	80	10	38,5	80	11,4	49,5	21	25/125
S0214N04	½" (DN 15)	50	15	40	80	9,5	49	25	15/75
S0214N05	¾" (DN20)	50	20	49,5	115	11	59	31	12/48
S0214N06	1" (DN25)	50	25	53,5	115	12,5	70	38	12/48
S0214N07	1¼" (DN32)	50	32	64	130	13,5	81	47	4/20
S0214N08	1½" (DN40)	40	40	74,5	150	15,5	94	54	4/8
S0214N09	2" (DN50)	40	50	90	170	17,5	112	66	2/8
S0214N10	2½" (DN65)	40	65	105,5	170	19,5	134	83	1/5
S0214N11	3" (DN82)	25	80	119,5	235	21	156	97	1/3
S0214N12	4" (DN100)	16	100	142	235	24	189	124	1/2

Valvola a sfera passaggio totale con leva alluminio, femmina/femmina, nichelata.
Full bore ball valve with aluminium lever, female/female, nickel-plated.