

TOPIC/EKO TOPIC

VALVOLA A SFERA A PASSAGGIO TOTALE UNI EN 10226
FULL BORE BALL VALVE UNI EN 10226

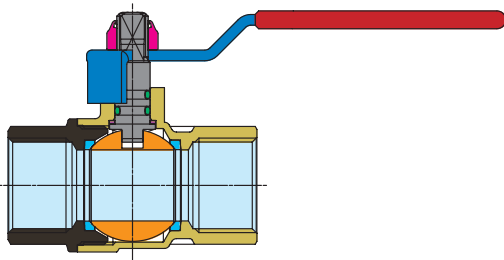

SPECIFICA MATERIALI MATERIAL SPECIFICATION



GUARDA IL VIDEO / WATCH THE VIDEO



PARTICOLARI COMPONENT

- **CORPO**
BODY
- **MANICOTTO**
END ADAPTER
- **SFERA**
BALL
- **SEDI LATERALI**
BALL GASKETS
- **PERNO**
STEM
- **ANELLO ANTIFRIZIONE**
THRUST WASHER
- **O-RINGS**
- **LEVA**
LEVER HANDLE
- FARFALLA O LEVA**
LEVER OR T-HANDLE
- **DADO AUTO-BLOCCANTE**
SELF-LOCKING NUT

MATERIALI MATERIAL

- CW 617 N UNI EN 12165
- CW 617 N UNI EN 12165
- CW 614 N UNI EN 12164
- PTFE
- CW 614 N UNI EN 12164
- PTFE
- ELASTOMERO
Elastomer
- ACCIAIO ZINCATO
Zinc-Plated Steel
- ALLUMINIO
Aluminium
- ACCIAIO
Steel

DESCRIZIONE DESCRIPTION

- STAMPATO DA BARRA, NICHELATO
Forged, Nickel-Plated
- STAMPATO DA BARRA, NICHELATO
Forged, Nickel-Plated
- DA BARRA, NICHEL-CROMATA
Machined, Chrome-Plated
- VERGINE
Virgin
- DA BARRA
Machined
- VERGINE
Virgin
- ADATTO ALL'USO PER ACQUA
Suitable For Use With Water
- PLASTIFICATA IN PVC
Pvc Insulated
- VERNICIATA
Painted
- ZINCATO
Zinc-Plated

FILETTATURE

Estremità filettate UNI EN 10226 (ex UNI 7/1).

END CONNECTIONS

Threaded ends UNI EN 10226 (ex UNI 7/1).

IMPIEGHI

Le valvole a sfera **TOPIC** sono adatte per l'uso con acqua calda e fredda, aria compressa, oli e idrocarburi in generale. Per utilizzi speciali vedere le tabelle di compatibilità chimica.

APPLICATIONS

The **TOPIC** ball valves are suitable for hot and cold water, compressed air, oils and hydrocarbons in general. For special uses please see the chemical resistance tables.

PRESSIONE DI ESERCIZIO

Da PN 50 (1/4") a PN 16 (4").
Vedere diagramma pressione/temperatura.

PRESSURE LIMITS

From PN 50 (size 1/4") to PN 16 (size 4").
See pressure/temperature diagram.

LIMITI DI TEMPERATURA

Da -20°C a +140°C.
Vedere diagramma pressione/temperatura.

TEMPERATURE LIMITS

From -20°C to + 140°C.
See pressure/temperature diagram.

Diagramma pressione/temperatura (prova eseguita con acqua)
Pressure/temperature diagram (tested with water)



Diagramma perdite di carico (prova eseguita con acqua)
Loss of head diagram (tested with water)



TOPIC/EKO TOPIC

VALVOLA A SFERA A PASSAGGIO TOTALE UNI EN 10226
FULL BORE BALL VALVE UNI EN 10226

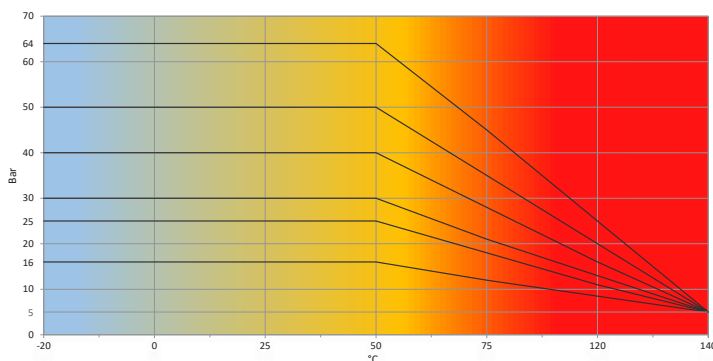
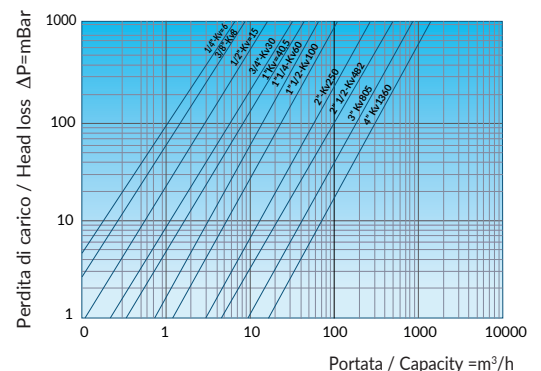
S1241 TOPIC USA

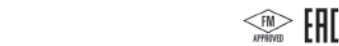

UL "VALVES, TRIM AND DRAIN (VQGU)" (WATER)

SP US Temperatura: -20°/+60°C (GAS)
Temperature: -20°/+60°C



Temperatura: -20°C/+130°C
Temperature: -20°C/+130°C

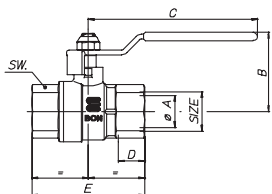

CODICE CODE	MISURA SIZE	PN Bar	øA	B	C	D	E	SW	Box Crt
S1241S92	¼" (DN8)	64	10	38	90	10,1	43,5	17	20/100
S1241S93	⅜" (DN10)	64	10	38	90	10,6	45	21	20/100
S1241S94	½" (DN15)	40	12,5	39,5	90	14,7	58,5	25	20/80
S1241S95	¾" (DN20)	40	20	49,5	105	14,2	64,5	31	12/48
S1241S96	1" (DN25)	40	25	51,5	105	16,8	77,5	38	8/32
S1241S97	1¼" (DN32)	40	32	62	140	17,3	89,5	47	4/20
S1241S98	1½" (DN40)	40	40	71	140	17,3	97	54	4/8
S1241S99	2" (DN50)	40	50	85,5	170	17,7	111,5	66	2/8
S1241S88	2½" (DN65)	40	65	99,5	170	23,8	141	83	1/5
S1241S89	3" (DN80)	25	80	113	250	25,8	162,5	97	1/5
S1241S90	4" (DN100)	16	100	139	250	27,8	192	124	1/2

Valvola a sfera, passaggio totale con leva, femmina/femmina, filetti NPT, sabbata. Full bore multi-purpose ball valve with steel lever, female/female, NPT thread, sand blasted.

S0201 EKO TOPIC

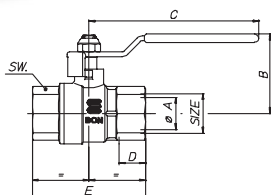

CODICE CODE	MISURA SIZE	PN Bar	øA	B	C	D	E	SW	Box Crt
S0201K32	¼" (DN8)	50	8	34,5	75	11	44,5	17	20/100
S0201K33	⅜" (DN10)	50	10	35,5	75	11,4	47	21	20/100
S0201K34	½" (DN15)	50	15	41	90	15	59,5	26	20/80
S0201K35	¾" (DN20)	50	20	49,5	105	16,3	70	32	12/48
S0201K36	1" (DN25)	50	25	53,5	105	19,1	83	38	8/32
S0201K37	1¼" (DN32)	50	32	66	120	21,4	98,5	47	4/20
S0201K38	1½" (DN40)	40	40	72	140	21,4	108	54	4/8
S0201K39	2" (DN50)	40	50	86	170	25,7	130	66	2/4
S0201K40	2½" (DN65)	40	65	96,5	170	30,2	158	83	1/5
S0201K41	3" (DN80)	25	80	112	250	33,3	181,5	97	1/3
S0201K42	4" (DN100)	16	100	127	250	39,3	219	124	1/2

Valvola a sfera passaggio totale con leva acciaio, femmina/femmina, nichelata. Full bore ball valve with steel handle, female/female, nickel-plated.

S0202 EKO TOPIC

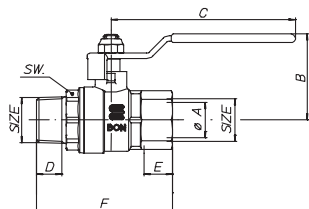

CODICE CODE	MISURA SIZE	PN Bar	øA	B	C	D	E	F	SW	Box Crt
S0202K32	¼" (DN8)	50	8	34,5	75	9	11	53	15/17	20/100
S0202K33	⅜" (DN10)	50	10	35,5	75	10	11,4	54	18/21	20/100
S0202K34	½" (DN15)	50	15	41	90	13,2	15	67	25	20/80
S0202K35	¾" (DN20)	50	20	50,5	105	14,5	16,3	77,5	31	12/48
S0202K36	1" (DN25)	50	25	115	105	16,8	19,1	89	38	8/32
S0202K37	1¼" (DN32)	50	32	130	120	19,1	21,4	103	47	4/20
S0202K38	1½" (DN40)	40	40	150	140	19,1	21,4	113,5	54	4/8
S0202K39	2" (DN50)	40	50	170	170	23,4	25,7	136,5	66	2/4

Valvola a sfera passaggio totale con leva acciaio, maschio/femmina, nichelata. Full bore ball valve with steel handle, male/female, nickel-plated.